

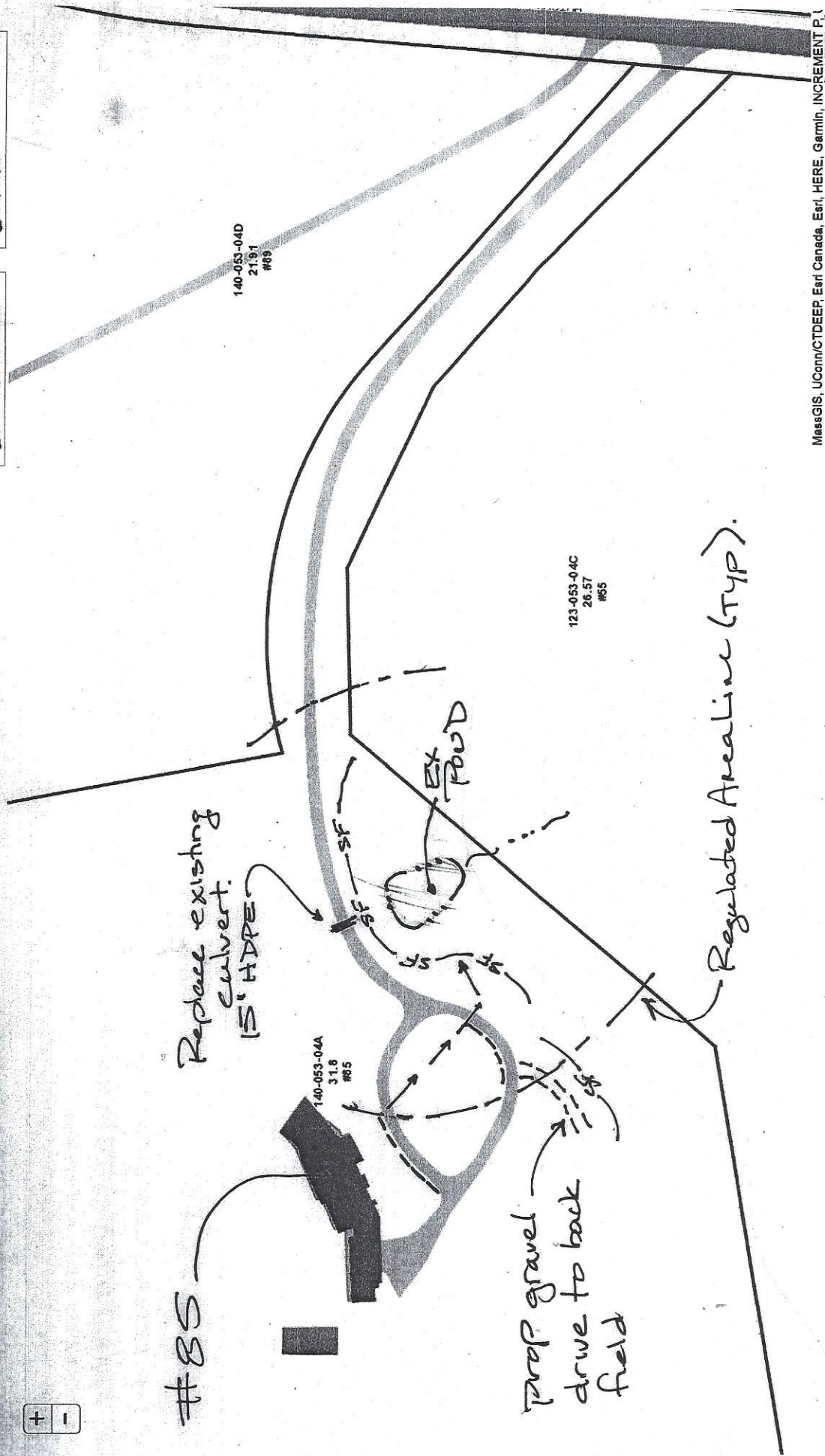

TOWN OF LITCHFIELD  
INLAND WETLANDS COMMISSION  
**APPLICATION TO CONDUCT ACTIVITY IN REGULATED AREA**

<b>Name of Applicant and Mailing Address:</b> <u>Harvey Hubbell V</u> <u>85 Hutchinson Pkwy</u> <u>Litchfield, CT 06759</u> <b>Email Address:</b> <u>capttimepro@gmail.com</u> <b>Phone:</b> <u>(860) 601-7855</u>		<b>Name of Property Owner:</b> <u>Harvey Hubbell V</u> <b>Address, or location of proposed activity:</b> <u>85 Hutchinson Pkwy</u> <b>Map</b> <u>140</u> <b>Block</b> <u>53</u> <b>Lot</b> <u>4A</u> <b>Total acreage of property:</b> <u>31.8Ac</u>	
<b>Description of proposed activity and acreage affected:</b> <u>Remove and Replace existing driveway, cross culvert, electric conduit and light posts in upland review area. Add underdrain as shown on Plan. No direct wetland impact.</u>			
<b>Acreage of buffer/upland review area altered:</b> <u>0.40 acres</u>			
<b>Effect of project on nearby wetlands and watercourses:</b> <u>None</u>			
<b>Effect of proposed activity on the vegetation and wildlife and types of vegetation and their percentages of total area:</b> <u>None</u>			
<b>Measures to prevent erosion and sedimentation:</b> <u>SILT Fence</u>			
<b>Measures to prevent flooding or surface run-off:</b> <u>No change to drainage patterns of existing driveway.</u>			
<b>Measures to prevent pollution of wetlands:</b> <u>Silt Fence</u>			
<small>The applicant understands that this application will be accepted only when complete and that further information may be required by the Commission to aid in its decision. The applicant should also recognize that members of the Commission and the Town Professional staff and other advisors shall have the right of free access to the property under consideration for inspection of all reasonable times and upon reasonable notice. The undersigned warrants the truth of all statements contained herein and all supporting documents according to his or her best knowledge and belief. If the applicant is not the owner of the property involved in this application, written consent from the owner should be obtained.</small>			
<b>Signature of Applicant</b> <u>MH</u>		<b>Signature of Owner</b> <u>HH</u>	
<b>Date Submitted</b>		<b>Date</b> <u>4/6/21</u>	
<b>Date Received</b>		<b>Fee:</b> \$ <u>140.-</u>	
<b>Public Hearing</b>			



- ..... Water
- - - - Regulated Area Line
- - - - Proposed Underdrain
- - - - Proposed 4" PVC
- SF - Proposed salt fence

Sketch Plan  
85 Hutchinson Pkwy.  
Litchfield CT  
4/2/21









## Statewide Inland Wetlands & Watercourses Activity Reporting Form

*Please complete and mail this form in accordance with the instructions on pages 2 and 3 to:  
Wetlands Management Section, Inland Water Resources Division, CT DEEP, 79 Elm Street – 3<sup>rd</sup> Floor, Hartford, CT 06106*

### PART I: To Be Completed By the Municipal Inland Wetlands Agency Only

1. DATE ACTION WAS TAKEN: Year \_\_\_\_\_ Month \_\_\_\_\_
2. ACTION TAKEN: \_\_\_\_\_
3. WAS A PUBLIC HEARING HELD (check one)? Yes ☐ No ☐
4. NAME OF AGENCY OFFICIAL VERIFYING AND COMPLETING THIS FORM:  
(type name) \_\_\_\_\_ (signature) \_\_\_\_\_

### PART II: To Be Completed By the Municipal Inland Wetlands Agency or the Applicant

5. TOWN IN WHICH THE ACTION IS OCCURRING (type name): Litchfield  
Does this project cross municipal boundaries (check one)? Yes ☐ No ☒  
If Yes, list the other town(s) in which the action is occurring (type name(s)): \_\_\_\_\_, \_\_\_\_\_
6. LOCATION (click on hyperlinks for information): USGS Quad Map Name: West Torrington or Quad Number: 33  
Subregional Drainage Basin Number: 6704
7. NAME OF APPLICANT, VIOLATOR OR PETITIONER (type name): Harvey Hubbell, V
8. NAME & ADDRESS/LOCATION OF PROJECT SITE (type information): 85 Hutchinson Parkway  
Briefly describe the action/project/activity (check and type information): Temporary ☐ Permanent ☒ Description: Remove and replace existing driveway, cross culvert, electric conduit and light poles in upland review area. Add underdrain as shown on plan.
9. ACTIVITY PURPOSE CODE: A
10. ACTIVITY TYPE CODE(S): 12, 14, NA, NA
11. WETLAND / WATERCOURSE AREA ALTERED (type in acres or linear feet as indicated):  
Wetlands: 0.00 acres      Open Water Body: 0.00 acres      Stream: 0.00 linear feet
12. UPLAND AREA ALTERED (type in acres as indicated): 0.40 acres
13. AREA OF WETLANDS / WATERCOURSES RESTORED, ENHANCED OR CREATED (type in acres as indicated): 0.00 acres

DATE RECEIVED:

### PART III: To Be Completed By the DEEP

DATE RETURNED TO DEEP:

FORM COMPLETED: YES NO

FORM CORRECTED / COMPLETED: YES NO